

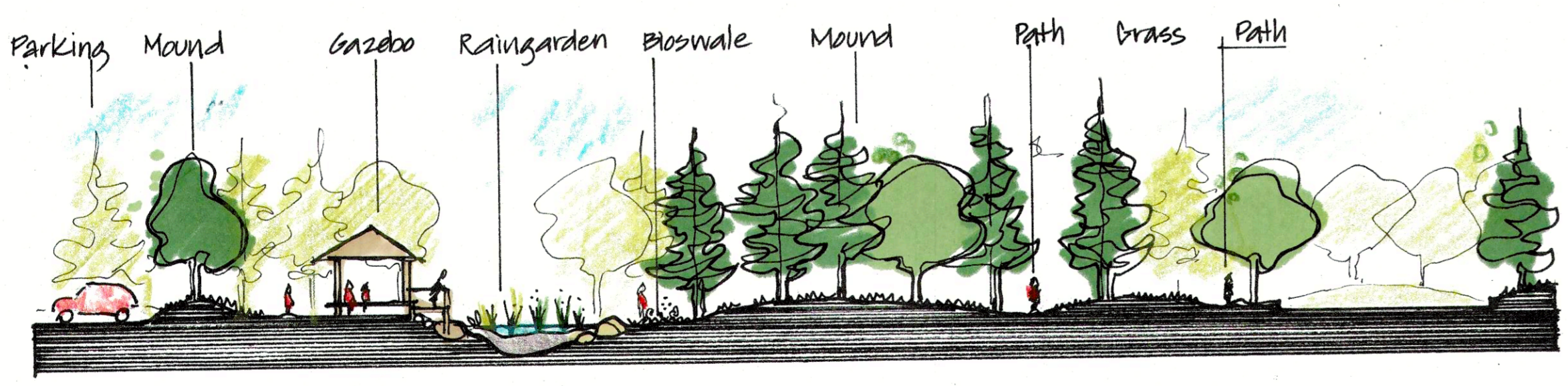

AMENITY AREA PLAN



SECTION A-A1

plant palette

Key	Botanical Name	Common Name	Pot Size
<b>Large/Medium Deciduous Trees</b>			
Ap	Acer palmatum	Japanese maple	2.5m ht
Am	Acer macrophyllum	Big Leaf Maple	2.5m ht
Ce	Cornus nuttallii eddies white wonder	Eddies White Wonder Dogwood	6 cm cal
Ck	Cornus kousa	Chinese Dogwood	2m ht
Ls	Liquidambar styraciflua	Sweet gum	6 cm cal
Pp	Parrotia persica	Persian Ironwood	6 cm cal
Og	Quercus garryana	Garry Oak	5 gall
<b>Evergreen Trees</b>			
Pob	Picea omorika bruns	Serbian Spruce	2.0 m ht
Pcc	Pinus contorta contorta	Shore Pine	1.5m ht
Pfv	Pinus flexilis vanderwolf	Vanderwolf Pine	2m ht
Pn	Pinus nigra	Austrian Pine	2m ht
<b>Evergreen Shrubs/fern</b>			
Gs	Gaultheria shallon	Santal	#1
Mn	Mahonia nervosa	Oregon Grape	#1
Vo	Vaccinium ovatum	Evergreen Huckleberry	#1
Pmun	Polystichum munitum	Sword Fern	#1
<b>Bioswale/Raingarden</b>			
Cstol	Cornus stolonifera	Red Twigg'd Dogwood	#1
Mg	Myrica gale	Sweet Gale	#1
Rp	Rubus parviflorus	Thimbleberry	#1
Co	Carex obnupta	Slough Sedge	plugs
Ie	Iris ensata	Japanese Iris	#1
Je	Juncus effusus	Common Rush	plugs
Sm	Scirpus microcarpus	Small flowered bullrush	#1

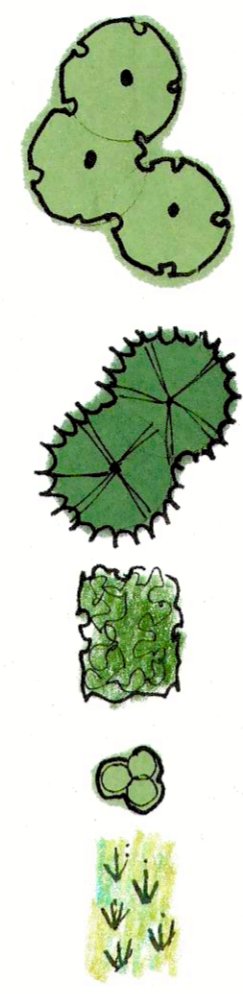

context plan



TRAIL / BOWEN ROAD ACCESS

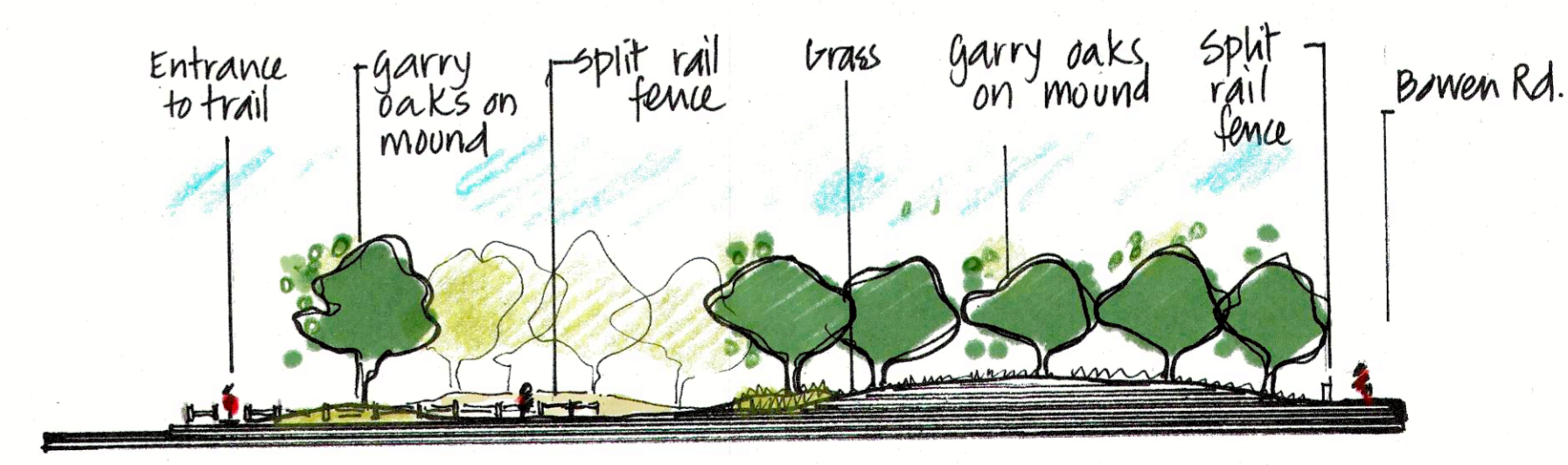

SECTION B-B1

DATE	REV.	DESCRIPTION
CONSULTANT		
<b>VICTORIA DRAKEFORD</b> B.Sc. (Landscape Architecture)		
<b>LANDSCAPE ARCHITECT</b> 236 Pine St. Nanaimo, B.C. V9R-2B6 250-754-4335 victoria@island.net		
PROJECT		
<b>PROPOSED MULTI-FAMILY RESIDENTIAL DEVELOPMENT</b> Caspers Way, Nanaimo		
SHEET TITLE		
<b>CONCEPTUAL LANDSCAPE PLAN</b> Amenity Area Bowen Rd Access Trail		
SCALE: 250m	DATE July 3, 19	
DRAWN VJD	CHECKED	
PROJECT NUMBER		
DRAWING NUMBER L1		

RECEIVED  
 RA442  
 2019-AUG-01  
 Current Planning